

Quick Service Guide: GOW-15/4-150 Bailian Booster Compressor

Date: 16 September 2025

This document was developed by [Build Health International](https://www.bhioxygen.org) to support global medical oxygen infrastructure planning, site preparation, operation, maintenance, and sustainability. Additional technical resources are available at www.bhioxygen.org.

This quick service guide for the Bailian GOW-15/5-150 booster compressor is designed to support technicians during preventative maintenance on the booster compressor. It is not a step-by-step instruction manual for completing maintenance, but rather a reference tool to assist with the more challenging and detail-oriented aspects of the process. On the following pages, you will find reference points such as:

- Proper valve assembly
- Correct stage placement
- Identification and positioning of rings and components

The intent is to provide clear, visual reminders that help reduce errors and ensure efficient, accurate maintenance.

The following pages are intended to be printed on A4 size paper and laminated for durability. Make sure to print at 100% scale without enlarging or modifying any of the image images to ensure the sizing guide sheets remain accurate. This is critical for verifying O-ring sizes, which will not display correctly if the images are resized. Store this guide in close proximity to the booster compressor for easy access during maintenance. By keeping this guide available at the point of use, technicians can quickly confirm critical details without searching through lengthy manuals.

This guide is an independent reference document. It is not endorsed, published, or developed by the booster compressor manufacturer. Always consult the official service manual for complete instructions, safety guidelines, and detailed maintenance procedures.

GOW15 BAILIAN QUICK SERVICE REFERENCE GUIDE

1st & 2nd STAGE

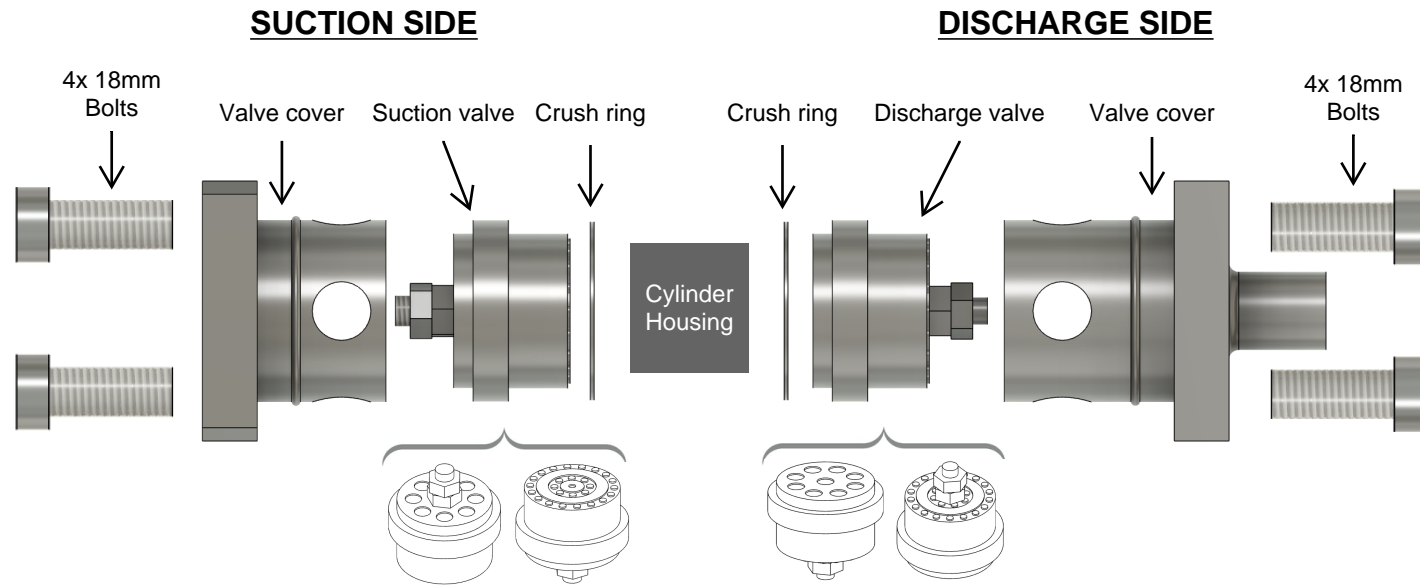

4th Stage Piston:

Notice the orientation of the piston. Observe that the side with the hole closest to the end is oriented towards the cylinder head.

Use the 10mm bolt to remove the cylinder from the casing.

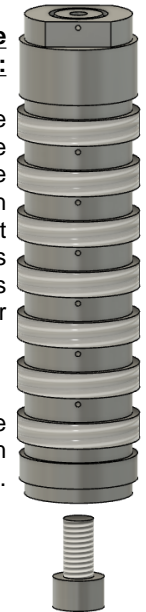

3rd & 4th STAGE

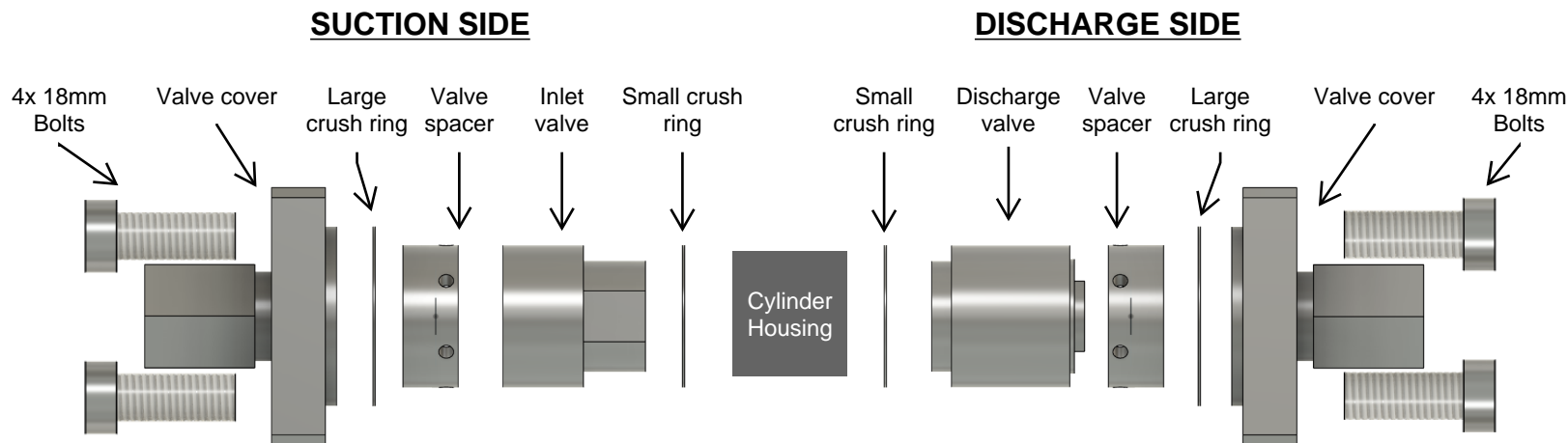

Use one of the valve cover bolts to pull out the inlet/discharge valves on stages 3 & 4

GOW15 BAILIAN QUICK SERVICE REFERENCE GUIDE

Use an 18mm wrench for all blue outside bolts on the valve covers and cylinder housings. These are Grade 8.8 bolts, torqued to 160 ft/lbs.

Use an 19mm wrench for most of the tubing connections

Discharge	3rd Stage	2nd Stage	1st Stage	Inlet
2030-2175 psi	812-986 psi	319-464 psi	130-217 psi	43-58 psi
14-15 MPa	5.6-6.8 MPa	2.2-3.2 MPa	0.9-1.5 MPa	0.3-0.4 MPa

FRONT VIEW

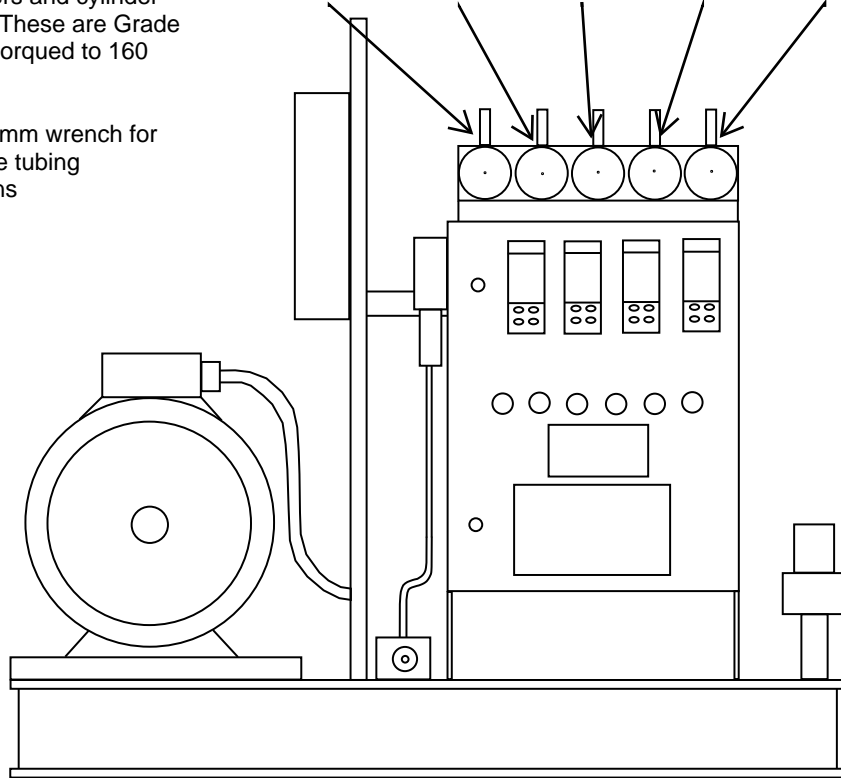

SIDE VIEW

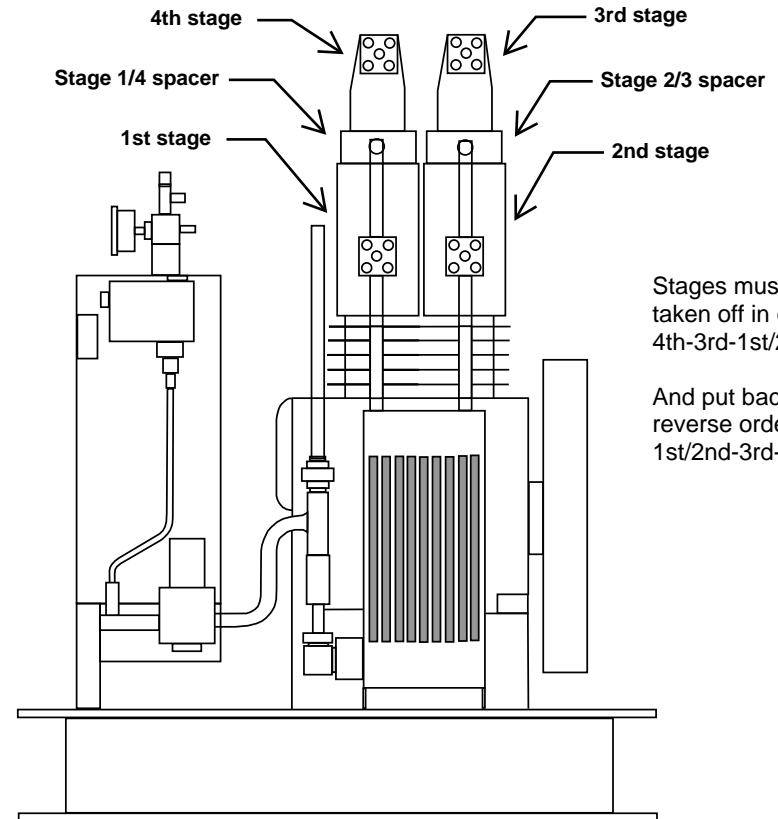

Stages must be taken off in order 4th-3rd-1st/2nd.

And put back in reverse order 1st/2nd-3rd-4th.

TOP VIEWS

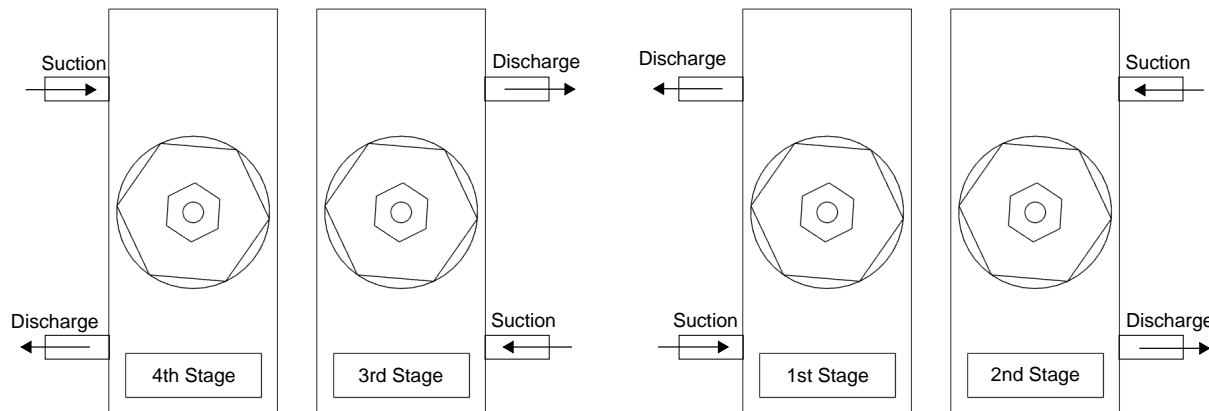

The Stage Spacers

Make sure to orient properly, the extrusion side shown should be placed face down

