

Quick Service Guide: RIX 2PS Booster Compressor

Date: 16 September 2025

This document was developed by [Build Health International](https://www.bhioxygen.org) to support global medical oxygen infrastructure planning, site preparation, operation, maintenance, and sustainability. Additional technical resources are available at www.bhioxygen.org.

This quick service guide for the RIX 2PS booster compressor is designed to support technicians during preventative maintenance on booster compressors. It is not a step-by-step instruction manual for completing maintenance, but rather a reference tool to assist with the more challenging and detail-oriented aspects of the process. On the following pages, you will find reference points such as:

- Proper valve assembly
- Correct stage placement
- Identification and positioning of rings and components

The intent is to provide clear, visual reminders that help reduce errors and ensure efficient, accurate maintenance.

The following pages are intended to be printed on A4 size paper and laminated for durability. Make sure to print at 100% scale without enlarging or modifying any of the image images to ensure the sizing guide sheets remain accurate. This is critical for verifying O-ring sizes, which will not display correctly if the images are resized. Store this guide in close proximity to the booster compressor for easy access during maintenance. By keeping this guide available at the point of use, technicians can quickly confirm critical details without searching through lengthy manuals.

This guide is an independent reference document. It is not endorsed, published, or developed by the booster compressor manufacturer. Always consult the official service manual for complete instructions, safety guidelines, and detailed maintenance procedures.

RIX 2PS QUICK SERVICE REFERENCE GUIDE

1ST STAGE

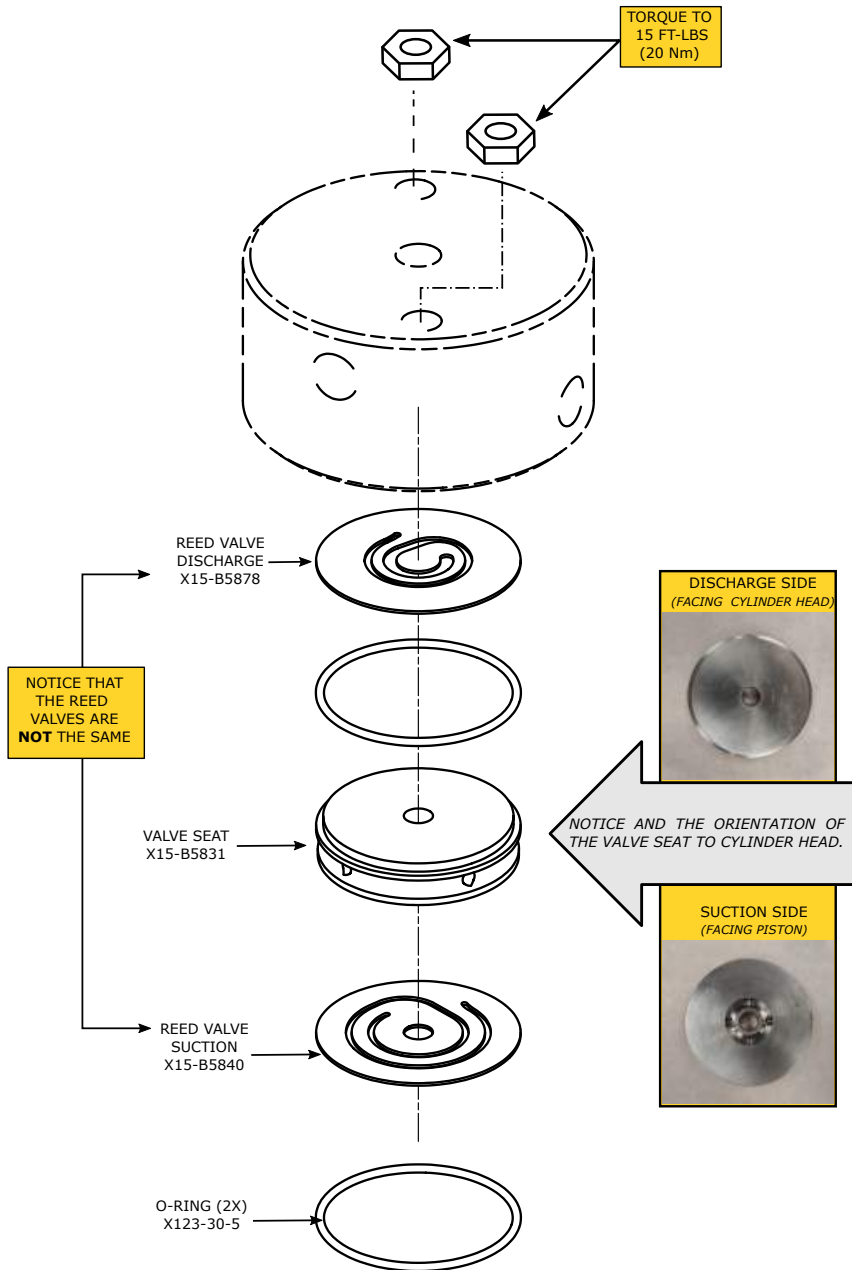

2ND STAGE

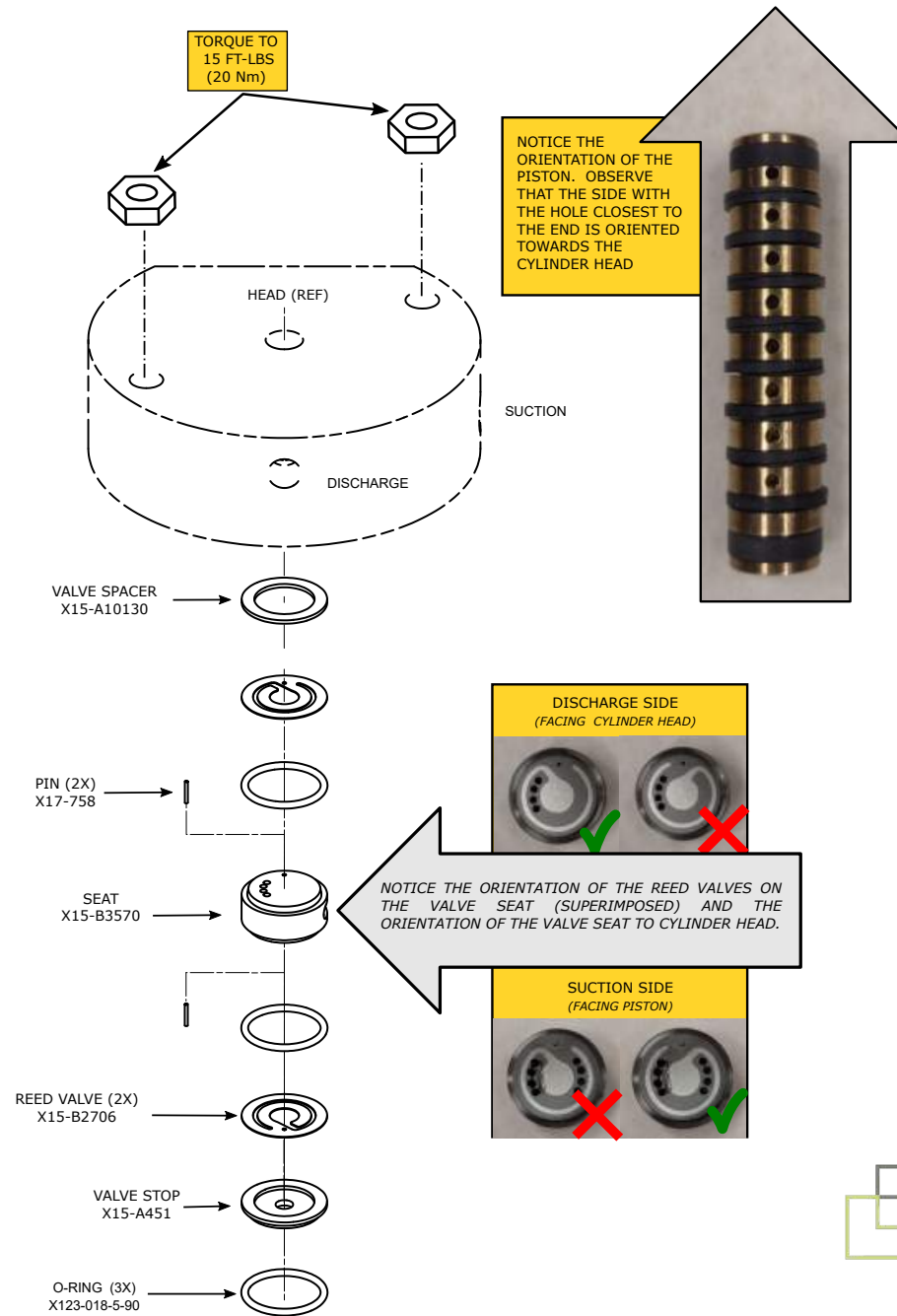

RIX 2PS QUICK SERVICE REFERENCE GUIDE

2ND STAGE CLEARANCE

.012"-.016"
0.30 -0.41 mm

ADJUSTMENT IS REQUIRED IF NEW PISTON OR ASSEMBLY IS INSTALLED. ADJUSTED BY ROTATING CYLINDER HOUSING

IF NEW PISTON IS CALLED. UNDER

O₂ OUTLET SWITCH (PSIG)
SHUTDOWN - 2200
RESTART - 1900

O₂ INLET SWITCH (PSIG)
SHUTDOWN - 25
RESTART - 28

15 FT-LBS
20 Nm

1ST STAGE CLEARANCE

.011"-.015"
0.28 -0.38 mm

ADJUSTMENT IS ONLY REQUIRED IF CONNECTING ROD OR ASSEMBLY IS CHANGED. ADJUST WITH SHIMS

NORMAL PRESSURE

(PSIG)

INLET 30-70 **1ST STAGE** 350-600 **2ND STAGE** 1500-2200

